

注: A - D 为重点检验尺寸。

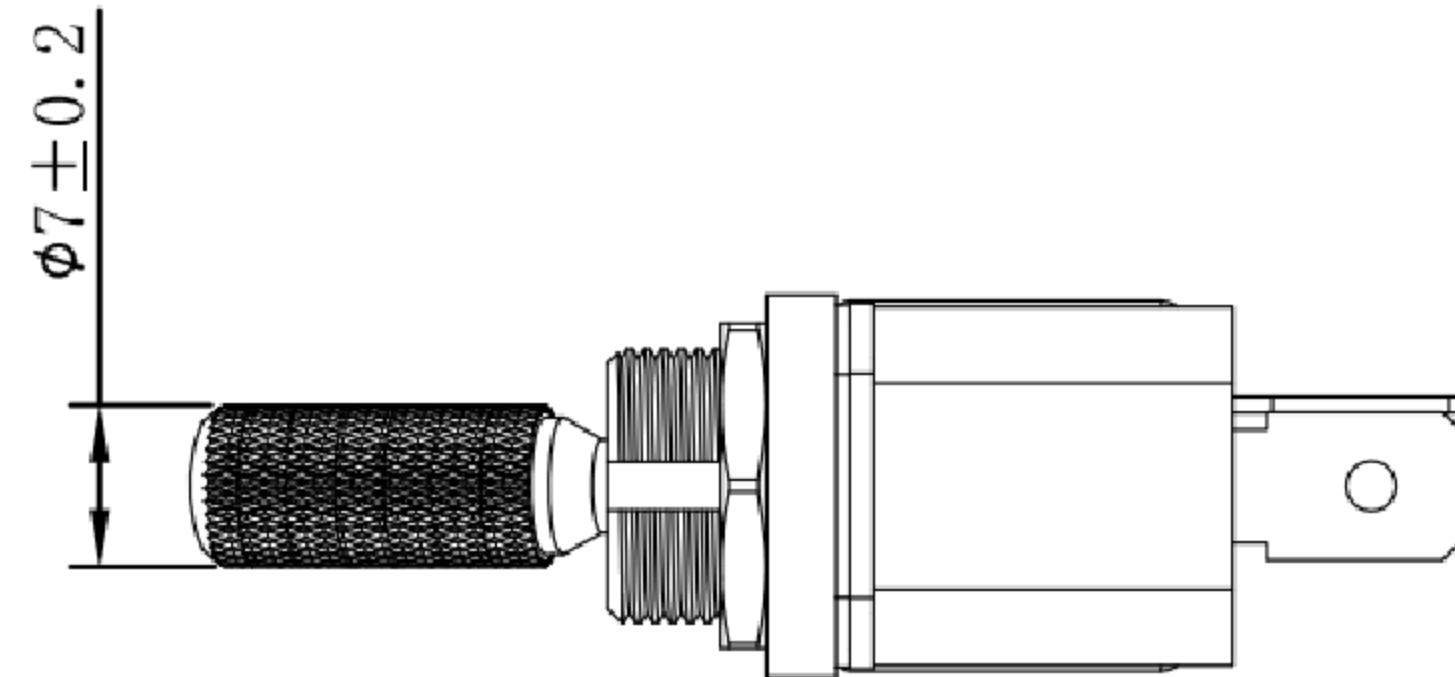
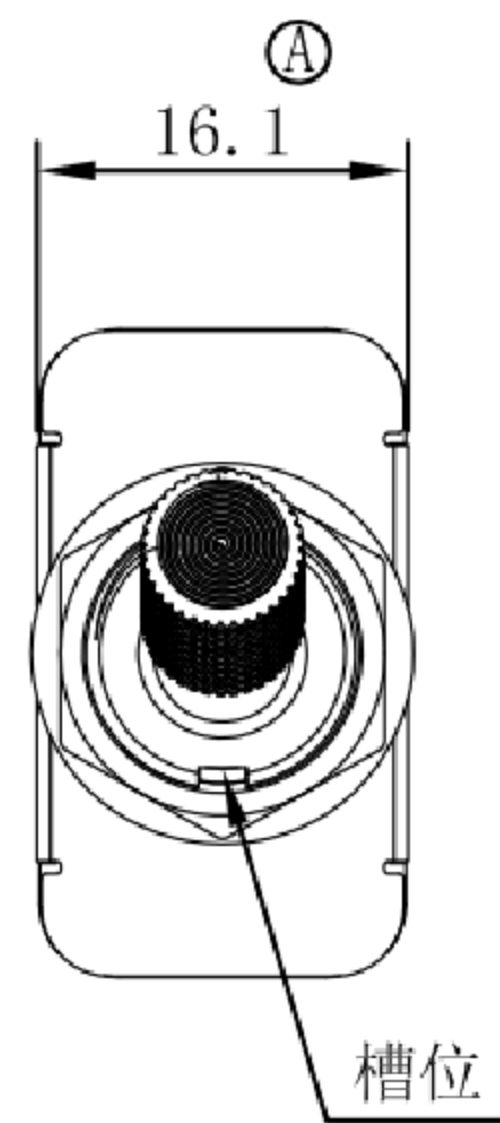
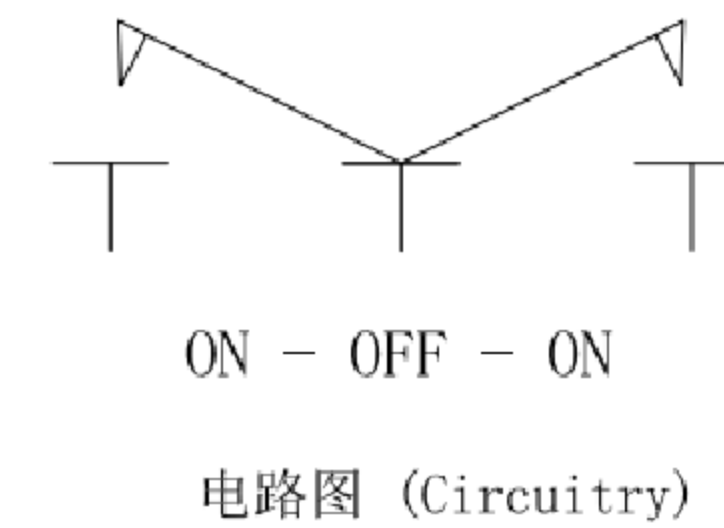

Technical characteristics

SPECIFICATION: 15 A max. @ 125 VAC.
 10 A max. @ 250 VAC.
 MECHANICAL LIFE: 40,000 make-and-break cycles.
 CONTACT RESISTANCE: 50mΩ max. initial @2-4VDC
 100mA for both silver.
 INSULATION RESISTANCE: 1000 MΩ min.
 DIELECTRIC STRENGTH: 1500 VAC min.
 OPERATING TEMPERATURE: -30°C to +85°C.

Materials

CASE: PF (UL 94V-0)
 HOUSING: SPCC.
 ACTUATOR: Alloy, nickel plated.
 BUSHING: Alloy, nickel plated.
 CONTACT/TERMINALS: Copper alloy silver plated.
 RoHS

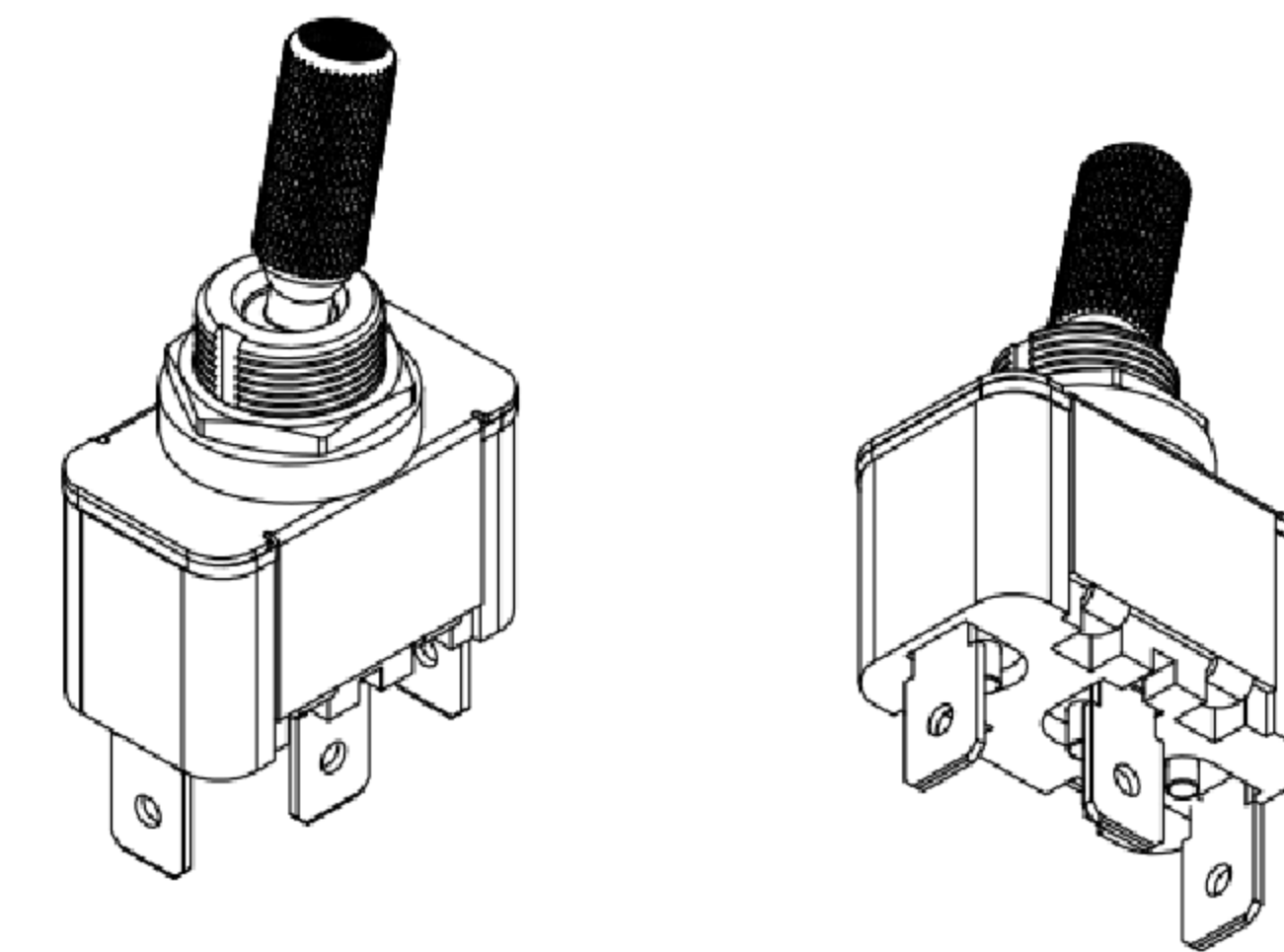

东莞市高迪电子有限公司
 DONG GUAN GAO DI ELECTRONICS CO., LTD

TOLERANCE UNLESS OTHERWISE STATED:

Up to 5 ±0.2
 Above 5 ~ 15 ±0.3
 Above 15 ~ 30 ±0.4
 Above 30 ~ 50 ±0.5
 Angle ±0.3°

3RD. ANGEL'S

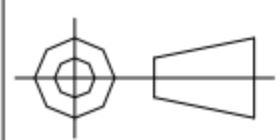

UNITS

MM

DRAWN BY: DATE
 Ming Ming Zou 07/23/13
 CHECKED BY: DATE
 Ning Ning Su 07/23/13
 APPROVED BY: DATE
 Jia Xiang 07/23/13

MAT'L		TITLE	Large toggle switch
FINISH		MODLE	Large toggle switch
SCALE	1:1	DWG NO.	GD-KN3-A-123-GP-M
SHEET NO.	1 of 1	PART NO.	

SIZE A4
 VER R2

2	公差及料號更新	Jack	072313
1	圖面更新	Frank Wu	021012
ITEM NO.	DESCRIPTION	DRAWN	DATE